

Universal lighting

SUNNEX HT is a small and convenient universal light which is ideally suited for all types of precision work. Supplied with a 10W halogen bulb, the Sunnex HT produces an extremely good spot light.

The lamp comes with either an plug-in transformer or in a low-voltage version for direct connection to machinery. Sunnex HT is fitted with a joint in the lamp head, making it flexible and easy to focus. The ergonomic design also means that the lamp is easy to keep clean.

Sunnex HT is available with a 500 mm flexible arm and in a spot version.

Areas of application

With the small outer dimensions and the high luminous efficiency, the Sunnex HT is well suited for precision work in offices, laboratories, precision mechanical workshops and for handicraft work.

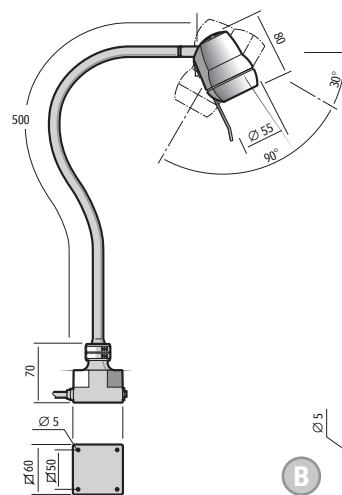

Lux rating - 0,5 m distance

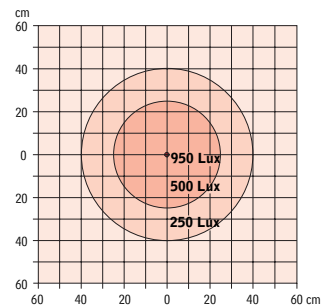

A

B

A HT FLEX ARM

- Halogen 10W
- Arm length 500 mm
- 230V/12V with plug-in transformer
- 12V or 24V
- Jointed lamp head
- IP20
- Colour; Black or White (RAL 9002)

B HT SPOT ARM

- Halogen 10W
- 230V/12V with plug-in transformer
- 12V or 24V
- Jointed lamp head
- IP20
- Colour; Black or White (RAL 9002)

	Arm	Connection	Art. No.
HT - Flex	500 mm	230V	22001
		12V	22002
		24V	22003
HT - Spot	Single joint	230V	22004
		12V	22005
		24V	22006

Industrial lighting

THE SHAPE of the Sunnex HS, in combination with its robust design and simple adjustment, has made the lamp a reliable industrial light for over 30 years.

Sunnex HS is fitted with Sunnex's classic flexible arm which is of extremely high quality and the lamp produces a extremely well focused spot light.

Sunnex HS comes with either an integral transformer or in a low-voltage version for direct connection to machinery. The light can also be supplied with a dimmer, and is available sealed to safety class IP20 or IP65.

Areas of application

Sunnex HS is available with a 500 or 700 mm flexible, bendable arm, as well as in the form of a spot with both single and double joint.

Examples of applications include spot lighting for manufacturing machines, machine tools, the graphic design, assembly work and precision mechanical work.

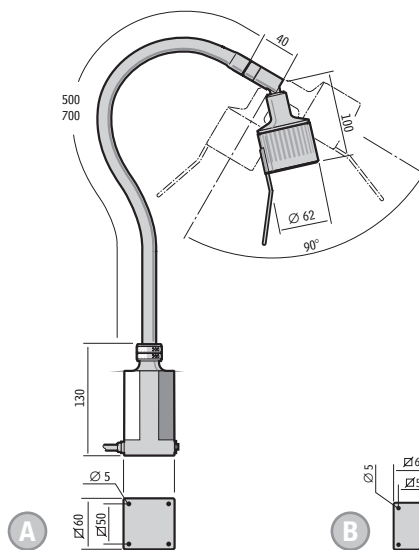

Lux rating - 0,5 m distance

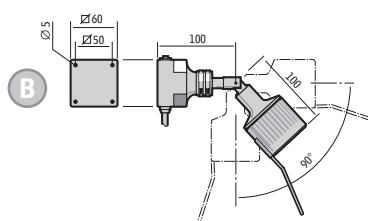
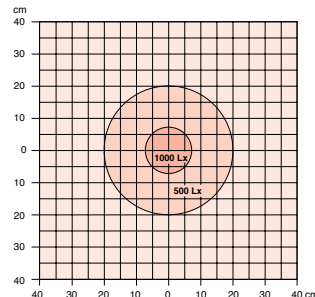

A HS FLEX ARM

- Halogen 20W
- Arm length 500 or 700 mm
- 230V/12V with integrated transformer
- 12V or 24V
- With or without jointed lamp head
- With or without dimmer
- IP20 or IP65
- Colour; Black or White (RAL 9002)

B HS SPOT ARM

- Halogen 20W
- 230V/12V with integrated transformer
- 12V or 24V
- Single or double jointed lamp head
- IP20 or IP65
- Colour; Black or White (RAL 9002)

	Arm	Connection	Other	Art. No.
HS - Flex	500 mm	230V	Joint	14100
		12V		14300
		24V		14400
HS - Spot	Single joint	230V		14160
		12V		14360
		24V		14460

For the complete Sunnex HS standard range, please click to next page.

	Arm	Connection	Other	Art. No.	
HS - Flex	500 mm	230V		14100	
			Joint	14110	
		12V		14300	
			Dimmer	14300DIM	
				IP65	14300IP65
			Joint	14310	
	24V		Joint/Dimmer	14310DIM	
				14400	
			Dimmer	14400DIM	
			IP65	14400IP65	
			Joint	14410	
			Joint/Dimmer	14410DIM	
	700 mm	230V		14120	
			Joint	14130	
		12V		14320	
			Dimmer	14320DIM	
				IP65	14320IP65
			Joint	14330	
		Joint/Dimmer	14330DIM		
		24V		14420	
			Dimmer	14420DIM	
			IP65	14420IP65	
			Joint	14430	
			Joint/Dimmer	14430DIM	

	Arm	Connection	Art. No.
HS - Spot	Single joint	230V	14160
		12V	14360
		24V	14460
	Double joint	230V	14163
		12V	14363
		24V	14463



Sunnex Equipment AB

Box 555, SE-686 28 Sunne, Sweden

Tel: +46 (0)565 177 00 • Fax: +46 (0)565 104 00

E-mail: info@sunnex.se • Web: www.sunnex.se



Sunnex is certified in accordance with ISO 9001:2008

PRODUCT INFORMATION

Sunnex HS is sold in Sunnex standard version. All Sunnex lighting products are supplied with screw mounts and in the colour black as standard. For further model descriptions, mounting devices and accessories, please see Sunnex web site or contact your dealer. To avoid the risk of injury, all assembly work should be performed by authorised personnel with the necessary knowledge of the product, its installation and its user environment. Sunnex reserve the right to alter components and to make design changes. This publication replaces previous editions.

Industrial lighting

SUNNEX HM is a small and effective workplace light which produces good, concentrated light. With a small external dimensions and flexible setting options, Sunnex HM blends in well in the working environment.

Sunnex HM has an integral electronic transformer, but is also available in a low-voltage version for direct connection to machinery. The flexible arm is of high quality, and is available in 500 and 700 mm long versions. The lamp head is made of impact-resistant thermosetting plastic and supplied with ventilation holes which efficiently dissipate heat from the halogen bulb.

Areas of application

Examples of applications include spotlighting for manufacturing machinery and machine tools, as well as for precision mechanical work.



A HM FLEX ARM

- Halogen 35W
- Arm length 500 or 700 mm
- 230V/12V electronic built-in transformer
- 12V or 24V
- With or without jointed lamp head
- With or without dimmer
- IP20 or IP65
- Colour; Black or White (RAL 9002)

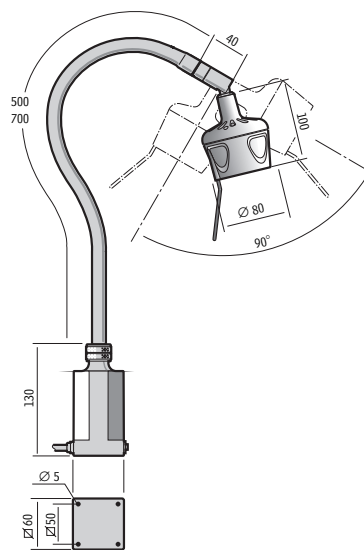

Lux rating - 0,5 m distance

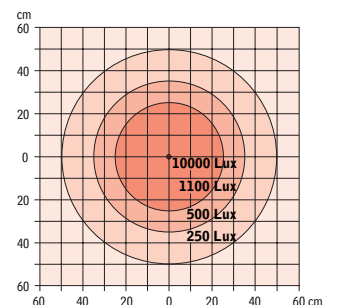

	Arm	Connection	Other	Art. No.
HM - Flex	500 mm	230V		23001
			Joint	23004
			12V	23002
		24V	Joint	23005
			Joint	23006
			Joint	23007
	700 mm	230V		23008
			Joint	23010
			12V	23009
		24V	Joint	23011
			Joint	23012
			Joint	23012

Machine light

SUNNEX HF is a powerful and stable machine light which is well suited for use in industries where cutting fluids, oils and moisture are present. Sunnex HF is fitted with Sunnex's classic flexible arm which is of extremely high quality. The lamp head is made of impact-resistant thermosetting plastic, and an easy-to-grip handle means that the light shade is simple to adjust. Sunnex HF comes with either an integral transformer or in a low-voltage version for direct connection to machinery, and is available sealed to safety class IP20 or IP65.



Areas of application

Sunnex HF is available with a 500 or 700 mm flexible arm, as well as in a spot version or with AAS arm. Examples of applications include spot lighting for external and internal placement in and on machine tools.



A HF FLEX ARM

- Halogen 50W or 75W
- Arm length 500 or 700 mm
- 230V/12V with electronic built-in transformer (50W)
- 12V or 24V
- With or without jointed lamp head
- IP20 or IP65 (IP65 only 12V/24V)
- Colour; Black or White (RAL 9002)

B HF SPOT ARM

- Halogen 50W or 75W
- 230V/12V with electronic built-in transformer (50W)
- 12V or 24V
- Single or double jointed lamp head
- IP20 or IP65
- Colour; Black or White (RAL 9002)

C HF AAS ARM

- Halogen 50W or 75W
- Arm length 1000 mm or 1250 mm
- 12V or 24V
- IP20 or IP65 (IP65 only 12V/24V)
- Colour; Black or White (RAL 9002)

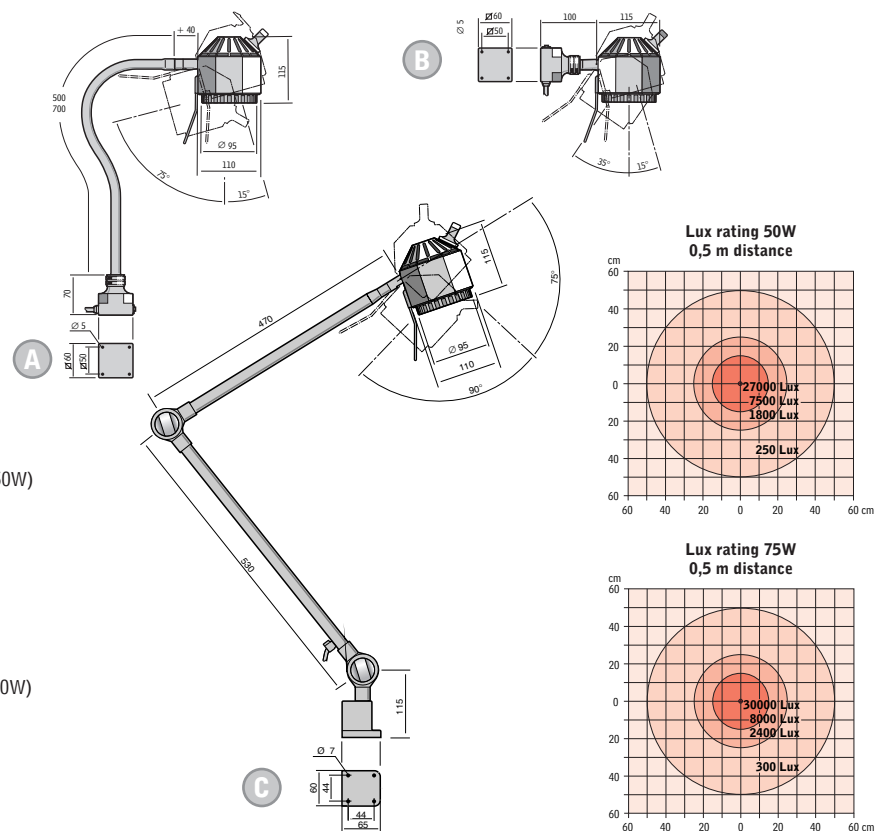

Arm	Connection	Watt	Art. No.
HF - Flex	500 mm	230V	12420E
		12V	12420
		24V	12620

For the complete Sunnex HF standard range, please see page 2 and 3.

	Arm	Connection	Other	Art. No.
HF - Flex 50W	500 mm	230V		12420E
			Joint	12430E
		12V		12420
			IP65	12420IP65
		24V	Joint	12430
				12620
	700 mm	230V	IP65	12620IP65
			Joint	12630
	700 mm	230V		12440E
			Joint	12450E
		12V		12440
			IP65	12440IP65
		24V	Joint	12450
				12640
		IP65	12640IP65	
		Joint	12650	

	Arm	Connection	Other	Art. No.	
HF - Flex 75W	500 mm	12V		12520	
			IP65	12520IP65	
		24V	Joint	12530	
				12720	
		700 mm	12V	IP65	12720IP65
				Joint	12730
	700 mm	12V		12540	
			IP65	12540IP65	
		24V	Joint	12550	
				12740	
				IP65	12740IP65
				Joint	12750



Sunnex Equipment AB

Box 555, SE-686 28 Sunne, Sweden
 Tel: +46 (0)565 177 00 • Fax: +46 (0)565 104 00
 E-mail: info@sunnex.se • Web: www.sunnex.se



Sunnex is certified in accordance with ISO 9001:2008

PRODUCT INFORMATION

Sunnex HF is sold in Sunnex standard version. All Sunnex lighting products are supplied with screw mounts and in the colour black as standard. For further model descriptions, mounting devices and accessories, please see Sunnex web site or contact your dealer. To avoid the risk of injury, all assembly work should be performed by authorised personnel with the necessary knowledge of the product, its installation and its user environment. Sunnex reserve the right to alter components and to make design changes. This publication replaces previous editions.

	Joint	Connection	Art. No.
HF - Spot 50W	Single	230V	12460E
		12V	12460
		24V	12660
	Double	230V	12462E
		12V	12462
		24V	12662

	Joint	Connection	Art. No.
HF - Spot 75W	Single	12V	12460E
		24V	12460
	Double	12V	12660
		24V	12462E

	Arm	Connection	Other	Art. No.
HF - AAS 50W	1000 mm	12V		12920
			IP65	12920IP65
		24V		12922
	1250 mm	12V		12922IP65
			IP65	12924
		24V		12924IP65
		24V		12926
			IP65	12926IP65

	Arm	Connection	Other	Art. No.
HF - AAS 75W	1000 mm	12V		12921
			IP65	12921IP65
		24V		12923
	1250 mm	12V		12923IP65
			IP65	12925
		24V		12925IP65
		24V		12927
			IP65	12927IP65



Sunnex Equipment AB
 Box 555, SE-686 28 Sunne, Sweden
 Tel: +46 (0)565 177 00 • Fax: +46 (0)565 104 00
 E-mail: info@sunnex.se • Web: www.sunnex.se



Sunnex is certified in accordance with ISO 9001:2008

PRODUCT INFORMATION

Sunnex HF is sold in Sunnex standard version. All Sunnex lighting products are supplied with screw mounts and in the colour black as standard. For further model descriptions, mounting devices and accessories, please see Sunnex web site or contact your dealer. To avoid the risk of injury, all assembly work should be performed by authorised personnel with the necessary knowledge of the product, its installation and its user environment. Sunnex reserve the right to alter components and to make design changes. This publication replaces previous editions.

Power LED lighting

SUNNEX LT is a small and convenient universal LED light which is ideally suited for all types of spot lighting. Supplied with a 2W Power LED light source, the Sunnex LT produces an stunning intensity for such a tiny light. The lamp comes with either an plug-in transformer or in a low-voltage version for direct connection to any kind of machinery. Sunnex LT is fitted with a joint in the lamp head, making it flexible and easy to use. The ergonomic design also means that the lamp is easy to keep clean.

Sunnex LT standard version is available with a 500 mm flexible arm and in a spot version.

Areas of application

With the small outer dimensions and the high luminous efficiency, the Sunnex LT is an universal light including precision work, medical and laboratorie equipment, and handicraft work.



A LT FLEX ARM

- Power LED 2W - 5,000 kelvin
- Arm length 500 mm
- 230V/12V/20VA, plug-in transformer
- 12V AC/DC
- Jointed lamp head
- Service life, LED light source >50.000 hours
- IP20
- Colour; Black or White (RAL 9002)

B LT SPOT ARM

- Power LED 2W - 5,000 kelvin
- 230V/12V/20VA, plug-in transformer
- 12V AC/DC
- Jointed lamp head
- Service life, LED light source >50.000 hours
- IP20
- Colour; Black or White (RAL 9002)

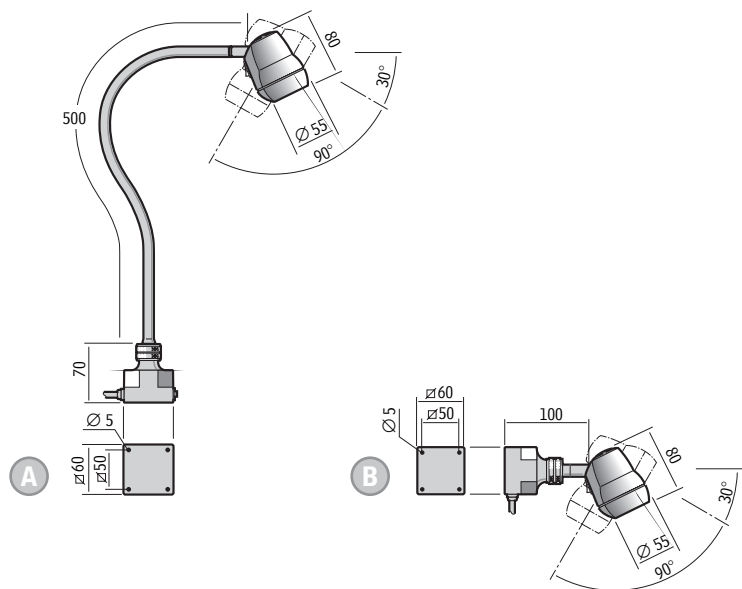

	Arm	Connection	Art. No.
LT - Flex	500 mm	230V	22601
		12V	22602
LT - Spot	Single joint	230V	22604
		12V	22605

Multi task LED light

SUNNEX LS is an efficient and powerful 3W LED lighting system in which the luminous efficiency is more or less identical to that of a 20W halogen light source.

Energy consumption is around 85% lower compared with halogen and the service life for the LED light source is more than >50,000 hours. All in all, this makes Sunnex LS an extremely interesting and economical alternative for any workplace lighting, that also has a minimal impact on the climate.

Areas of application

Sunnex LS is available with a 500 or 700 mm flexible, gooseneck arm, as well as in the form of a spot with both single and double joint.

Examples of applications include spot lighting for manufacturing machines, machine tools, marine applications, the graphic design, assembly work and precision mechanical work.

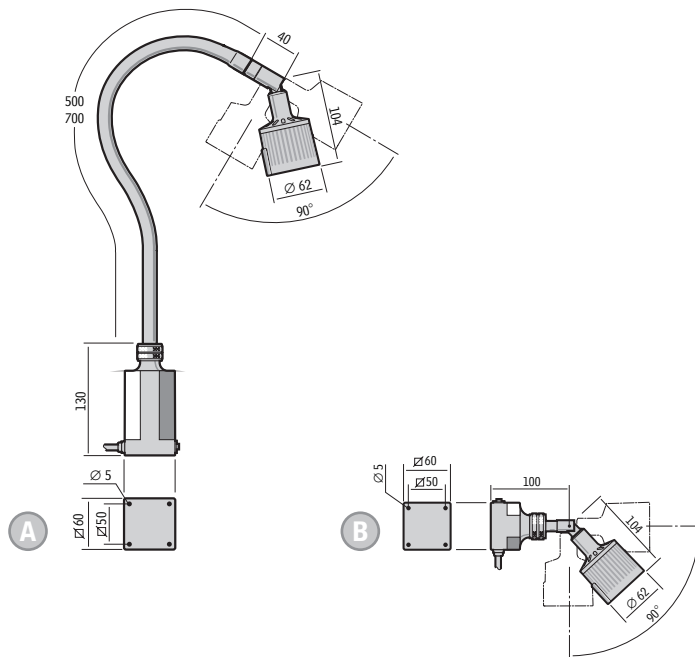

- A LS FLEX ARM**
- Power LED 3W - 3,000 kelvin
 - Arm length 500 or 700 mm
 - 230V with integrated transformer
 - 12V-24V
 - With or without jointed lamp head
 - Service life, LED light source >50.000 hours
 - IP20
 - Colour; Black

- B LS SPOT ARM**
- Power LED 3W - 3,000 kelvin
 - 230V/12V with integrated transformer
 - 12V-24V
 - Single or double jointed lamp head
 - Service life, LED light source >50.000 hours
 - IP20
 - Colour; Black

	Arm	Connection	Other	Art. No.
LS - Flex	500 mm	230V		30205
			Joint	30220
	700 mm	230V		30305
			12-24V	30310
		12-24V		30320
			Joint	30325
LS - Spot	40 mm	230V	Single joint	30230
		12-24V	Single joint	30330

Focused LED light

SUNNEX LM is a high-intensity, focused and powerful 3,6W LED light with the same light efficiency as a conventional 20W halogen light source.

The energy consumption is around 85% lower compared with halogen and the service life for the LED light source is more than >100,000 hours.

The robust, impact-resistant lamp head is made of aluminium and the entire light fitting is highly vibration-resistant. Thanks to the LED light source and vented lamp head, Sunnex LM produces virtually no heat and has a minimal impact on the environment.

Areas of application

Sunnex LM is available with a 500 or 700 mm flexible, gooseneck arm, as well as in the form of a spot with a single joint in lamp head.

The light is ideally suited for all types of applications, where lighting must produce a minimum amount of heat.

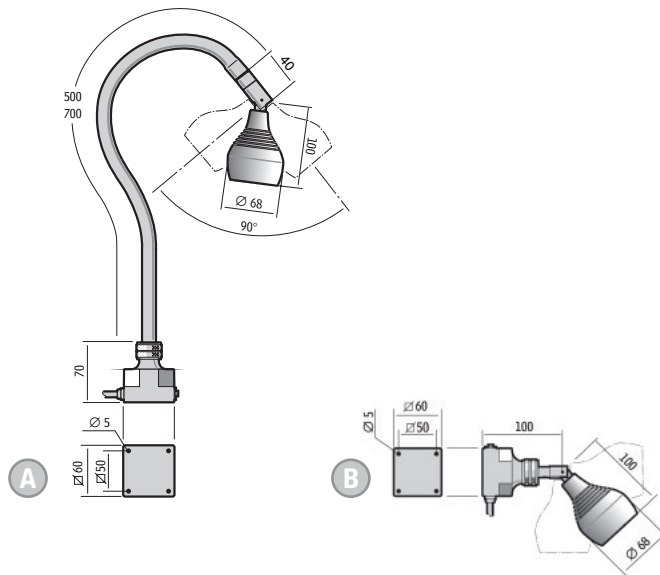

A LM FLEX ARM

- Power LED 3,6W - 4,000 kelvin
- Arm length 500 or 700 mm
- 230V with separate AC/DC adaptor
- 12V-24V
- With or without jointed lamp head
- Service life, LED light source >100.000 hours
- IP20
- Colour; Black

B LM SPOT ARM

- Power LED 3,6W - 4,000 kelvin
- 230V with separate AC/DC adaptor
- 12V-24V
- Single or double jointed lamp head
- Service life, LED light source >100.000 hours
- IP20
- Colour; Black

	Arm	Connection	Other	Art. No.
LM - Flex	500 mm	230V		30020
			Joint	30025
	700 mm	230V		30040
			Joint	30045
				30030
			Joint	30035
LM - Spot	40 mm	230V	Single joint	30021
		12-24V	Single joint	30011

Universal lighting

SUNNEX CL is based on compact fluorescent tubes with a long service life. The lamp head is available in two lengths, depending on the desired light output and it is made from extruded aluminium. The CL version is fitted with Sunnex's classic flexible gooseneck arm measuring 500 or 700 mm in length, and there is an integrated ballast in the base. The lens produces a low glare factor and an even circle of soft light. The model is pure in style, easy to keep clean and takes up little room.

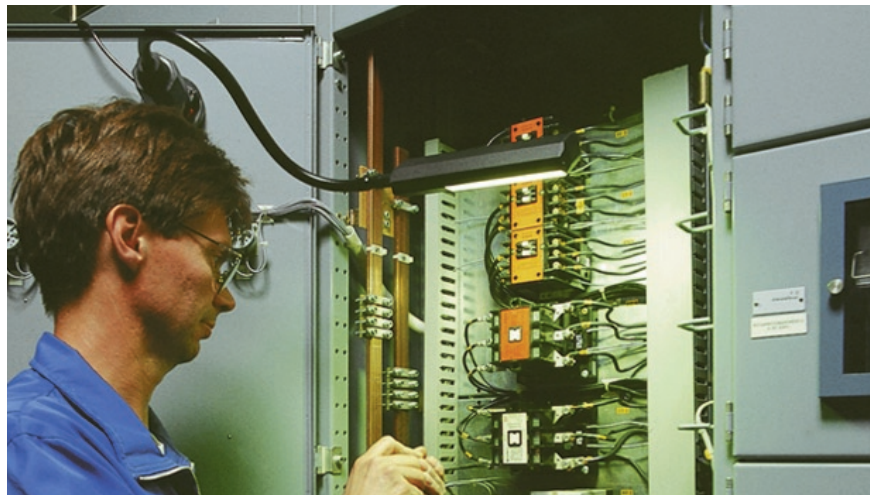

Areas of application

Suitable applications include measuring jigs and other heat-sensitive environments. Offices in general constitute another typical area of application. Sunnex CL is also chosen for large work surfaces, where a sharp contrast effect is to be avoided.



A CL FLEX ARM

- Fluorescent tube 9W or 11W
- Arm length 500 or 700 mm
- 230V integrated ballast
- Service life, >16,000 hours
- IP20
- Colour; Black or White (RAL 9002)

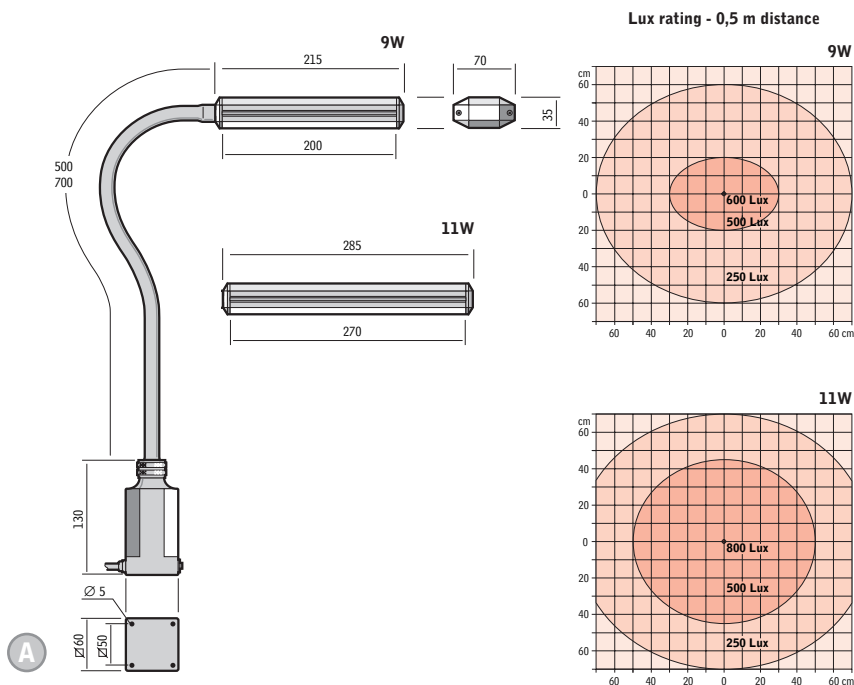
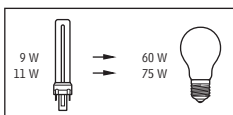

	Arm	Connection	Lamp Power	Art. No.
CL - Flex	500 mm	230V	9W	14810
			11W	14820
	700 mm	230V	9W	14860
			11W	14870

Magnifying light

SUNNEX RLM is a magnifying light with superior light intensity for detailed inspection. The magnification is 5 diopter (2,25X) and the light source is a 22W fluorescent ring light with low heat emission. The arm is has adjustable joints for easy and safe positioning, and two versions are offered, a c-clamp version and a mobile version. As a option there is a add-on lens (2,25X) available.

Sunnex RLM is pure in style, easy to keep clean and takes up little room.



Areas of application

Suitable applications is detailed inspection in offices, laboratories and workbenches.



A RLM - Magnifying light

- Magnification 2,25X
- Fluorescent tube 22W
- C-clamp and mobile version
- Arm length 880 mm
- 230V integrated ballast
- Joint in lamp head
- Service life, >10,000 hours
- Colour; Offwhite

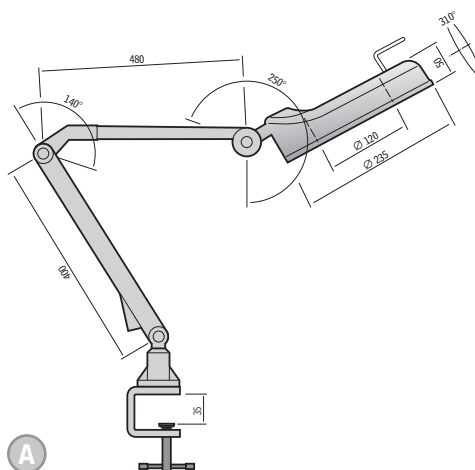

Lux rating - 0,15 m distance

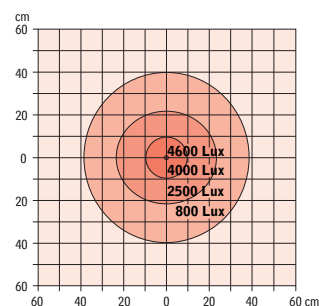

	Version	Connection	Lamp Power	Art. No.
RLM	C-clamp	230V	22W	RLM-CL-230V
	Mobile	230V	22W	RLM-CLT-230V
	Add-on lens 2,25X			RLM-5XMAG